

RECOMMENDED PCB LAYOUT  
(TOP VIEW)

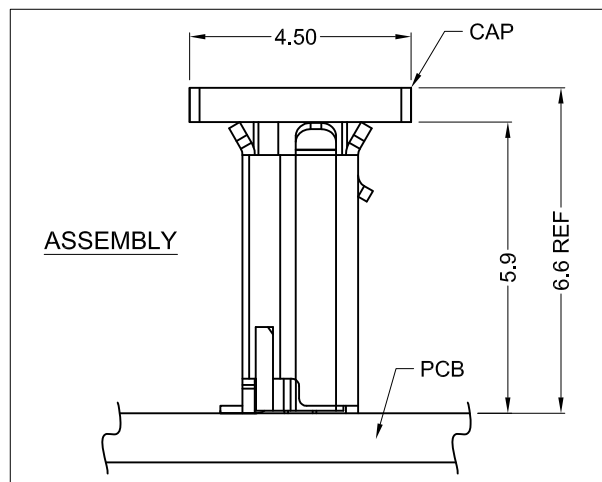

**Material and Finish**

Insulator: High Temperature  
Thermoplastic, UL 94V-0  
Rated, Color: Black  
Shell: Stainless Steel, Matte Tin Plated  
Contact Material:  
Phosphor Bronze  
Contact Plating Options:  
Standard: 10u" Gold Plated on  
Contact Area, Gold Flash on Solder  
Tails, All over Nickel Underplate  
50 Option: 50u" Gold Plated on  
Contact Area, Gold Flash on Solder  
Tails, All over Nickel Underplate

**Electrical Characteristics**

Rated Current: 1.5A  
Rated Voltage: 30V AC/DC  
Insulation Resistance:  
1,000 Megohms Min.  
Contact Resistance:  
30 milliohms Max.  
Dielectric Withstanding Voltage:  
100V AC For 1 Minute

**Mechanical Characteristics**

Durability: 10,000 Mating Cycles Min.  
Operating Temperature:  
-40°C to +105°C

Part Number	Insulator Color	Contact Area Plating Finish	Packaging
KMMVX-SMT-BS-BTR	Black	10u" Gold (standard)	Tape & Reel
KMMVX-SMT-BS-B50TR	Black	50u" Gold (50 option)	Tape & Reel

RoHS COMPLIANT

Tolerances
X.X ± 0.35
X.XX ± 0.25
Unless Stated Otherwise

REV.	DATE	DESCRIPTION	REV. BY	CHK. BY	DRAWN BY	DATE
A0	09/10/15	New Drawing	C. Kelleher	W. Cook	C. Kelleher	8/25/15
A1	09/22/15	Release Drawing	C. Kelleher	W. Cook		

KMMVX-SMT-BS-BxTR

Micro-B Socket, USB 2.0, SMT  
Vertical, RoHS Compliant



# Mouser Electronics

Authorized Distributor

Click to View Pricing, Inventory, Delivery & Lifecycle Information:

[Kycon:](#)

[KMMVX-SMT-BS-BTR](#)